

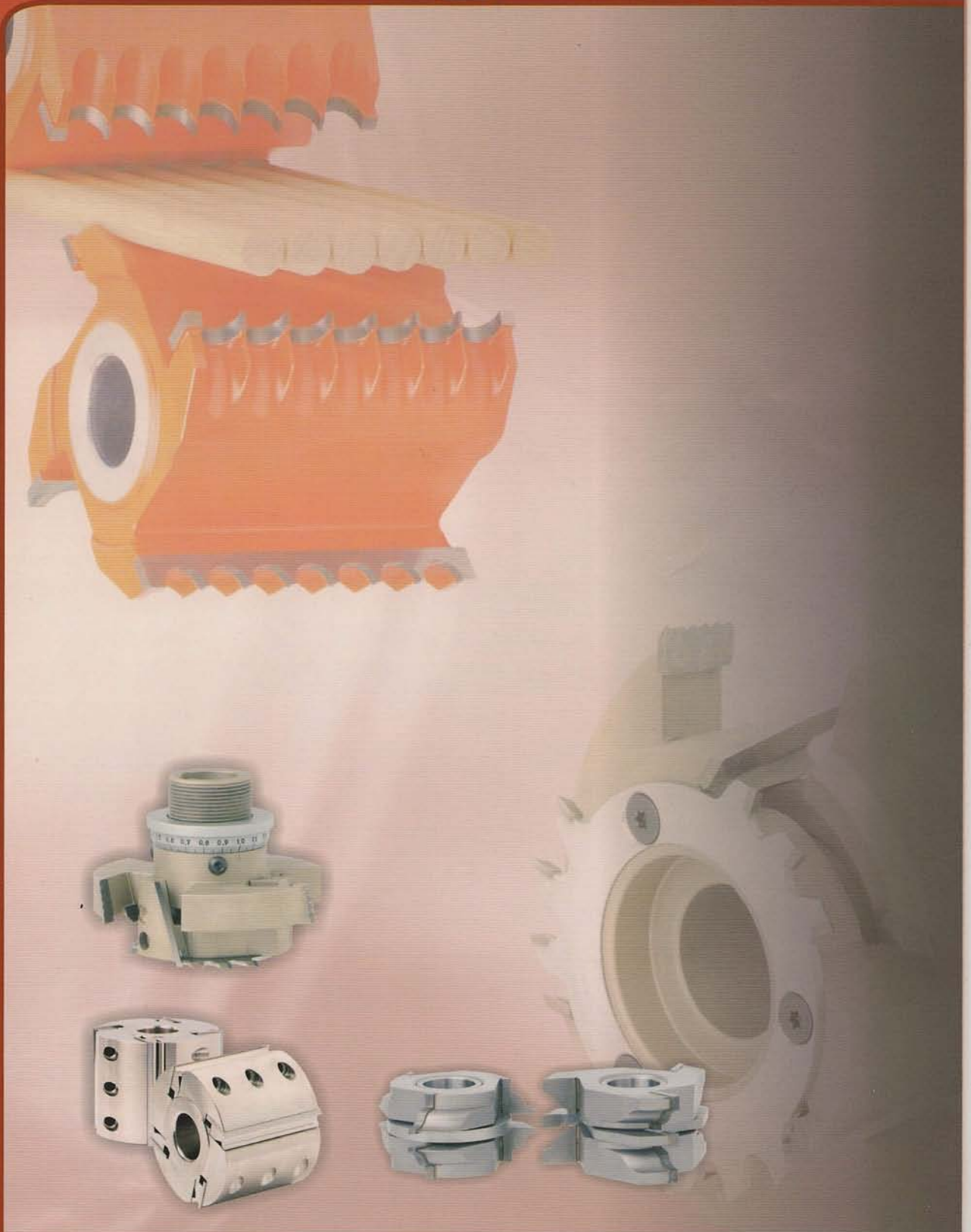

KS CUTTERS



專業製造 · 各種型體刀 · 木工刀具 · 超硬刀具

平刀系列 PLANING CUTTER SERIES

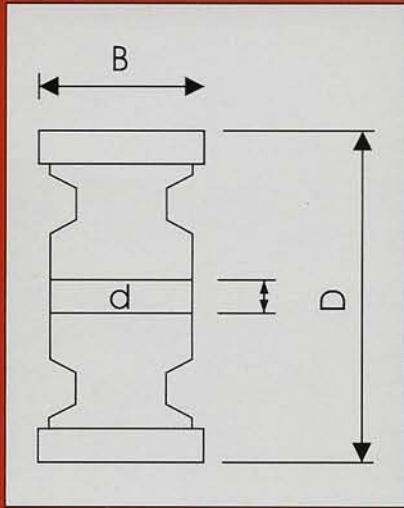

適用機型：

立軸，仿型，四面鉋木機等平面切削機
Spindle Shaper, Copy Shapping Machine, Four side Planer, Flate cutting Machine。

編號	外徑	長度	內徑	刃數
ITEM NO.	D (mm)	B (mm)	d (mm)	Z
KS-101	100	50	25.4/30/31.75/35/40	4T/6T
KS-102	100	75	25.4/31/31.75/35/40	4T/6T
KS-103	100	100	25.4/30/31.75/35/40	4T/6T
KS-104	100	125	25.4/30/31.75/35/40	4T/6T
KS-105	125	75	40/50	4T/6T
KS-106	125	100	40/50	4T/6T
KS-107	125	125	40/50	4T/6T
KS-108	125	155	40/50	4T/6T
KS-109	125	180	40/50	4T/6T
KS-110	125	205	40/50	4T/6T
KS-111	125	230	40/50	4T/6T
KS-112	125	255	40/50	4T/6T
KS-113	125	280	40/50	4T/6T
KS-114	125	305	40/50	4T/6T

固定式螺旋平刀

FIXED HELICAL PLANING CUTTER



KS CUTTERS

專業製造 · 各種型體刀 · 木工刀具 · 超硬刀具

編號	外徑	長度	內徑	刃數
ITEM NO.	D(mm)	B(mm)	d(mm)	Z
KS-201	100	50	25.4/30/31.75/35/40	6T
KS-202	100	75	25.4/30/31.75/35/40	6T
KS-203	100	100	25.4/30/31.75/35/40	6T
KS-204	100	125	25.4/30/31.75/35/40	6T
KS-205	125	75	40/50	6T/8T
KS-206	125	100	40/50	6T/8T
KS-207	125	125	40/50	6T/8T
KS-208	125	155	40/50	6T/8T
KS-209	125	180	40/50	6T/8T
KS-210	125	205	40/50	6T/8T
KS-211	125	230	40/50	6T/8T
KS-212	125	255	40/50	6T/8T
KS-213	125	280	40/50	6T/8T
KS-214	125	305	40/50	6T/8T

活動平刀

MOVEABLE PLANING CUTTER

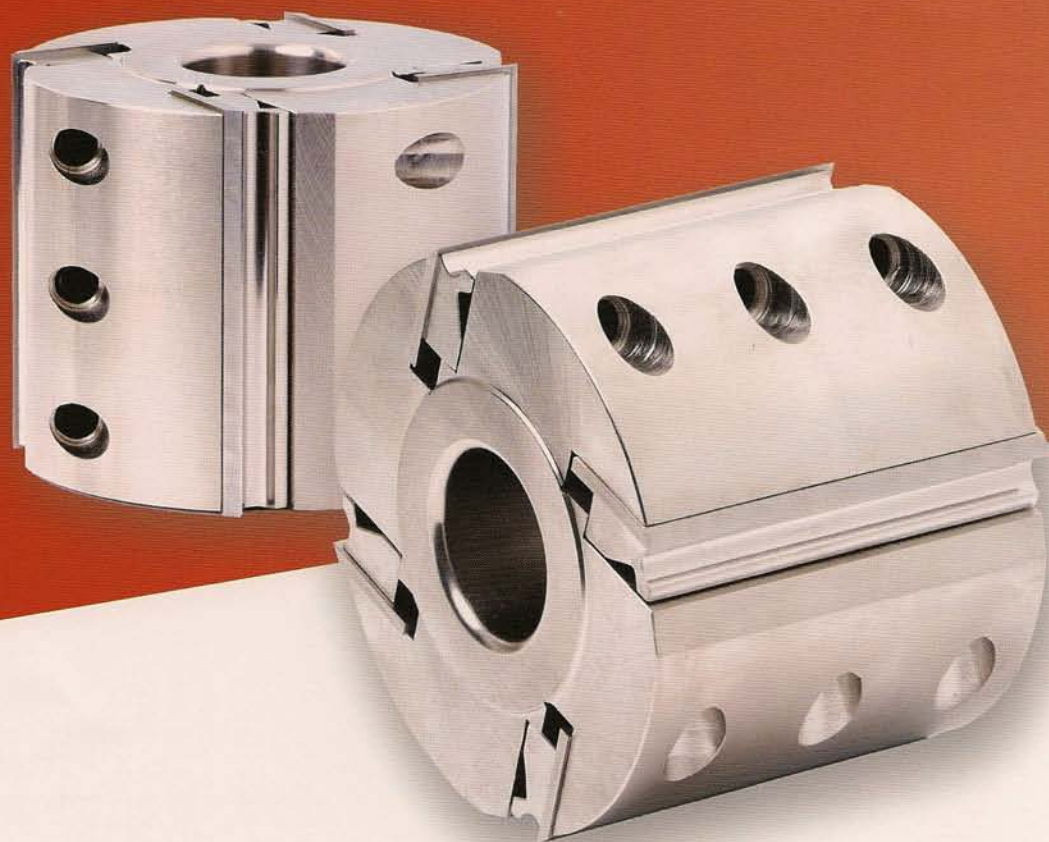

KS CUTTERS

專業製造 · 各種型體刀 · 木工刀具 · 超硬刀具

編號	外徑	長度	內徑	刃數
ITEM NO.	D(mm)	B(mm)	d(mm)	Z
KS-301	100	50	25.4/30/31.75/35/40	4T
KS-302	100	75	25.4/30/31.75/35/40	4T
KS-303	100	100	25.4/30/31.75/35/40	4T
KS-304	100	125	25.4/30/31.75/35/40	4T
KS-305	125	75	40/50	4T
KS-306	125	100	40/50	4T
KS-307	125	125	40/50	4T
KS-308	125	155	40/50	4T
KS-309	125	180	40/50	4T
KS-310	125	205	40/50	4T
KS-311	125	230	40/50	4T
KS-312	125	255	40/50	4T
KS-313	125	280	40/50	4T
KS-314	125	305	40/50	4T

1-4R 刀

RADIUS PROFILE CUTTER

KS CUTTERS

專業製造 · 各種型體刀 · 木工刀具 · 超硬刀具

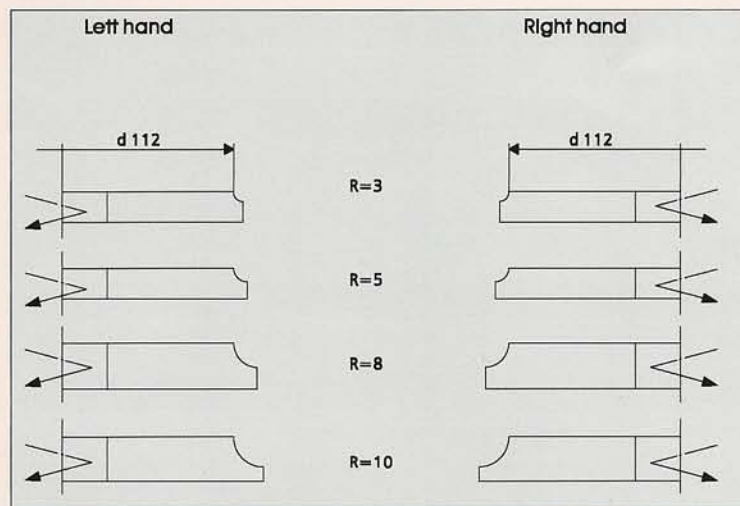
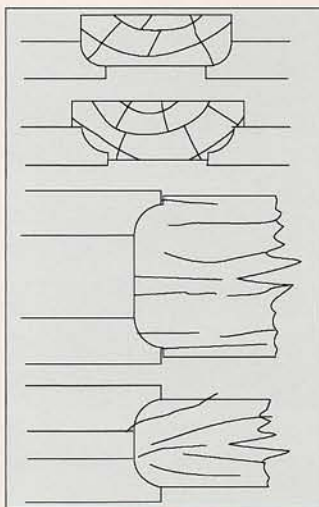

編號	外徑	長度	內徑	R數	刃數
ITEM NO.	D(mm)	B(mm)	d(mm)	R	Z
KS-401	106	8	25.4/30/31.75/40	3	4T/6T
KS-402	110	10	25.4/30/31.75/40	5	4T/6T
KS-403	116	13	25.4/30/31.75/40	8	4T/6T
KS-404	120	15	25.4/30/31.75/40	10	4T/6T
KS-405	130	20	25.4/30/31.75/40	15	4T/6T
KS-406	140	25	25.4/30/31.75/40	20	4T/6T
KS-407	150	30	25.4/30/31.75/40	25	4T/6T
KS-408	160	35	25.4/30/31.75/40	30	4T/6T

圓棒刀

ROUND ROD MILLING CUTTER

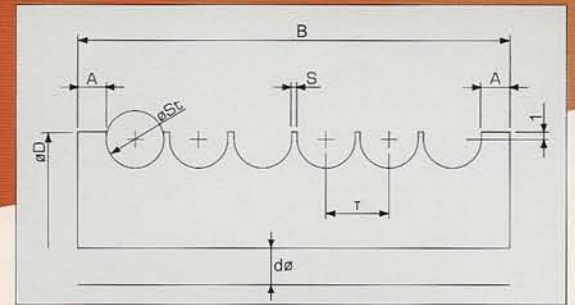
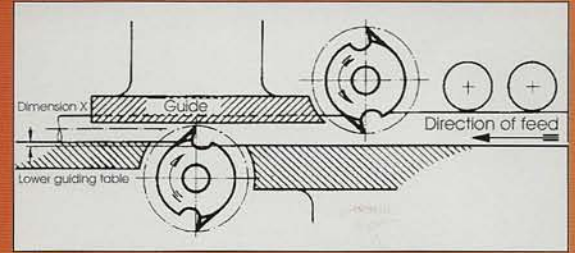
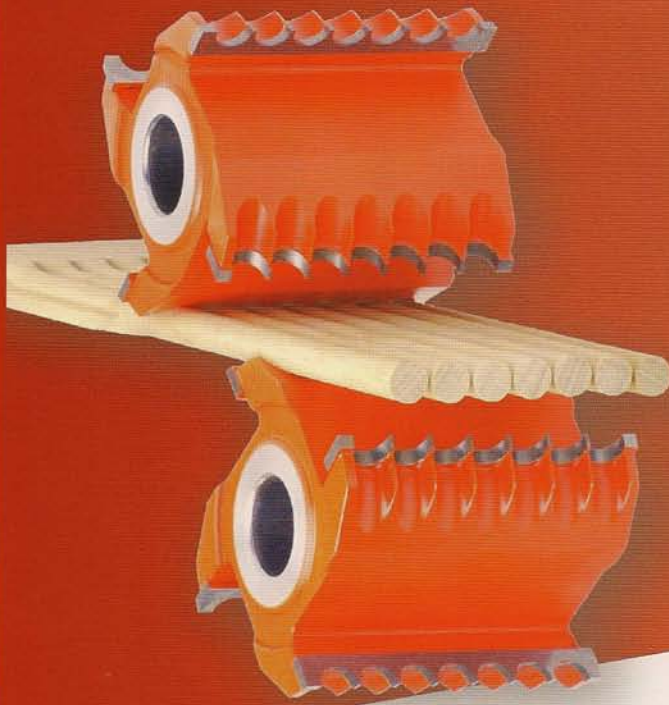
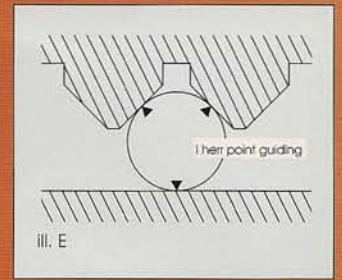

KS CUTTERS

專業製造 · 各種型體刀 · 木工刀具 · 超硬刀具

編號	外徑	長度	內徑	直徑	間距	節距	刃數
ITEM NO.	D(mm)	B(mm)	d(mm)	St(mm)	S(mm)	T(mm)	Z
KS-501	110/130	50/75/100/125	30/40	2	1	3	4T
KS-502	110/130	50/75/100/125	30/40	3	1	4	4T
KS-503	110/130	50/75/100/125	30/40	4	1	5	4T
KS-504	110/130	50/75/100/125	30/40	5	1	6	4T
KS-505	110/130	50/75/100/125	30/40	6	1	7	4T
KS-506	110/130	50/75/100/125	30/40	7	1	8	4T
KS-507	110/130	50/75/100/125	30/40	8	1	9	4T
KS-508	110/130	50/75/100/125	30/40	9	1	10	4T
KS-509	110/130	50/75/100/125	30/40	10	1.5	11.5	4T
KS-510	110/130	50/75/100/125	30/40	11	1.5	12.5	4T
KS-511	110/130	50/75/100/125	30/40	12	1.5	13.5	4T
KS-512	110/130	50/75/100/125	30/40	13	1.5	14.5	4T
KS-513	110/130	50/75/100/125	30/40	14	1.5	15.5	4T
KS-514	110/140	50/75/100/125	30/40	15	1.5	16.5	4T
KS-515	110/140	50/75/100/125	30/40	16	1.5	17.5	4T
KS-516	110/140	50/75/100/125	30/40	17	1.5	18.5	4T
KS-517	110/140	50/75/100/125	30/40	18	1.5	19.5	4T
KS-518	110/140	50/75/100/125	30/40	19	1.5	20.5	4T
KS-519	110/140	50/75/100/125	30/40	20	2	22	4T
KS-520	110/140	50/75/100/125	30/40	21	2	23	4T
KS-521	110/140	50/75/100/125	30/40	22	2	24	4T
KS-522	110/140	50/75/100/125	30/40	23	2	25	4T
KS-523	110/140	50/75/100/125	30/40	24	2	26	4T
KS-524	110/140	50/75/100/125	30/40	25	2	27	4T

花棒刀

DOWEL MILLING CUTTER

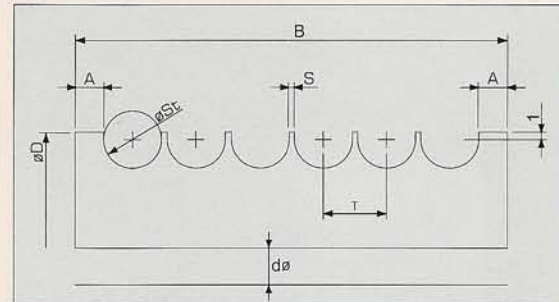
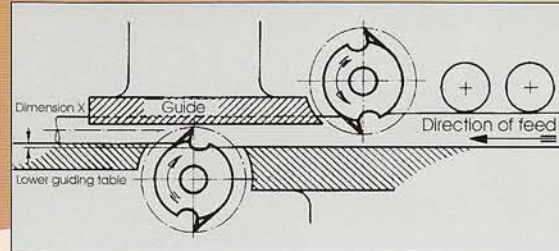
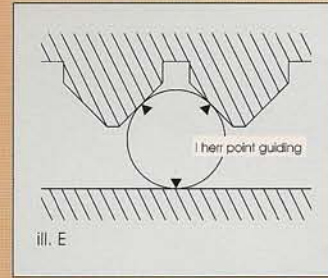

編號	外徑	長度	內徑	直徑	間距	節距	刃數
ITEM NO.	D(mm)	B(mm)	d(mm)	St(mm)	S(mm)	T(mm)	Z
KS-601	110/130	50/75/100	30/40	5	1.5	6.5	4T
KS-602	110/130	50/75/100	30/40	6	1.5	7.5	4T
KS-603	110/130	50/75/100	30/40	7	1.5	8.5	4T
KS-604	110/130	50/75/100	30/40	8	1.5	9.5	4T
KS-605	110/130	50/75/100	30/40	9	1.5	10.5	4T
KS-606	110/130	50/75/100	30/40	10	1.5	11.5	4T
KS-607	110/130	50/75/100	30/40	11	1.5	12.5	4T
KS-608	110/130	50/75/100	30/40	12	1.5	13.5	4T
KS-609	110/130	50/75/100	30/40	13	1.5	14.5	4T
KS-610	110/130	50/75/100	30/40	14	1.5	15.5	4T
KS-611	110/140	50/75/100	30/40	15	1.5	16.5	4T
KS-612	110/140	50/75/100	30/40	16	1.5	17.5	4T
KS-613	110/140	50/75/100	30/40	17	1.5	18.5	4T
KS-614	110/140	50/75/100	30/40	18	1.5	19.5	4T
KS-615	110/140	50/75/100	30/40	19	1.5	20.5	4T

KS CUTTERS

專業製造 · 各種型體刀 · 木工刀具 · 超硬刀具

地板榫刀

FLOOR-JOINTING CUTTER

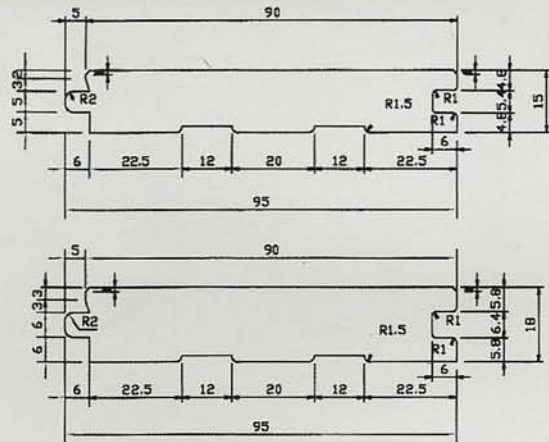
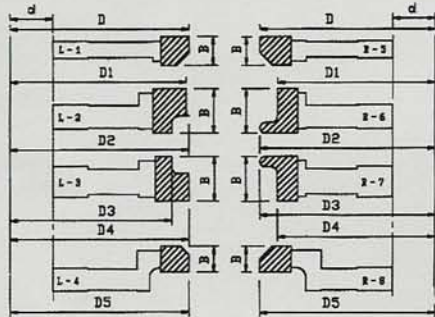
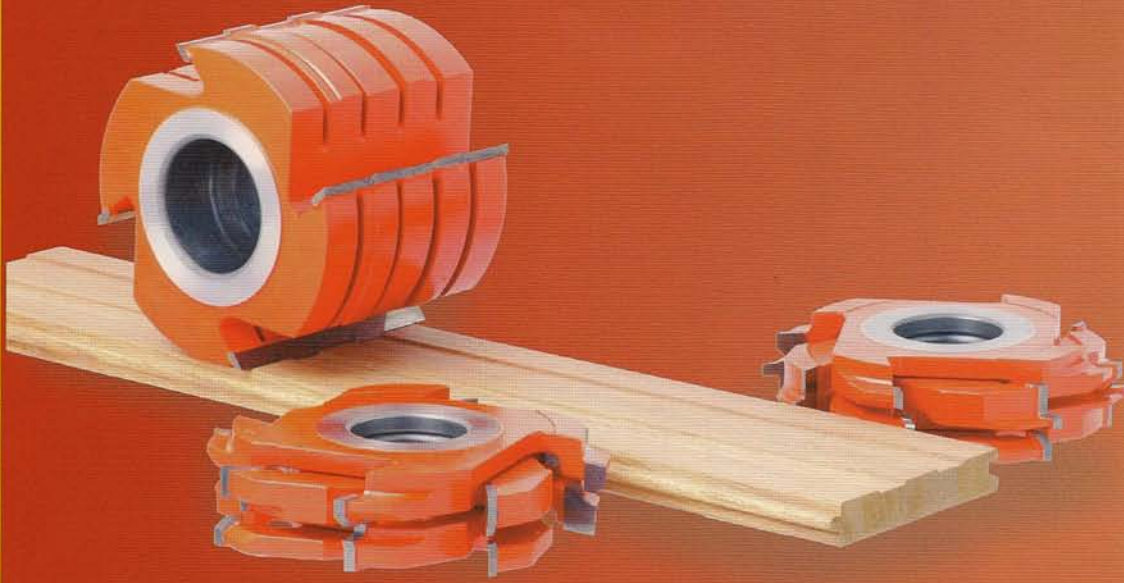

機械	編號	直徑	長度	內徑	刃數
MACHINE	ITEM NO.	D=mm	B=mm	d=mm	Z
四面鉋榫刀 FOUR SIDE MOULDER	L-1	D=141	10	40/50	4T/6T
四面鉋榫刀 FOUR SIDE MOULDER	L-2	D1=135, D2=137	15	40/50	4T/6T
四面鉋榫刀 FOUR SIDE MOULDER	L-3	D3=125, D4=137	15	40/50	4T/6T
四面鉋榫刀 FOUR SIDE MOULDER	L-4	D5=143	10	40/50	4T/6T
四面鉋榫刀 FOUR SIDE MOULDER	R-5	D=131	10	40/50	4T/6T
四面鉋榫刀 FOUR SIDE MOULDER	R-6	D1=125, D2=137	15	40/50	4T/6T
四面鉋榫刀 FOUR SIDE MOULDER	R-7	D3=137, D4=125	15	40/50	4T/6T
四面鉋榫刀 FOUR SIDE MOULDER	R-8	D5=131	10	40/50	4T/6T
雙端作榫刀 DOUBLE END TENONER	L-1	D=153	10	25.4/30	6T
雙端作榫刀 DOUBLE END TENONER	L-2	D1=147, D2=149	15	25.4/30	6T
雙端作榫刀 DOUBLE END TENONER	L-3	D3=137, D4=149	15	25.4/30	6T
雙端作榫刀 DOUBLE END TENONER	R-5	D=143	10	25.4/30	6T
雙端作榫刀 DOUBLE END TENONER	R-6	D1=137, D2=149	15	25.4/30	6T
雙端作榫刀 DOUBLE END TENONER	R-7	D3=149, D4=137	15	25.4/30	6T

KS CUTTERS

專業製造 · 各種型體刀 · 木工刀具 · 超硬刀具

地板底刀

FLOOR BOTTOM CUTTER

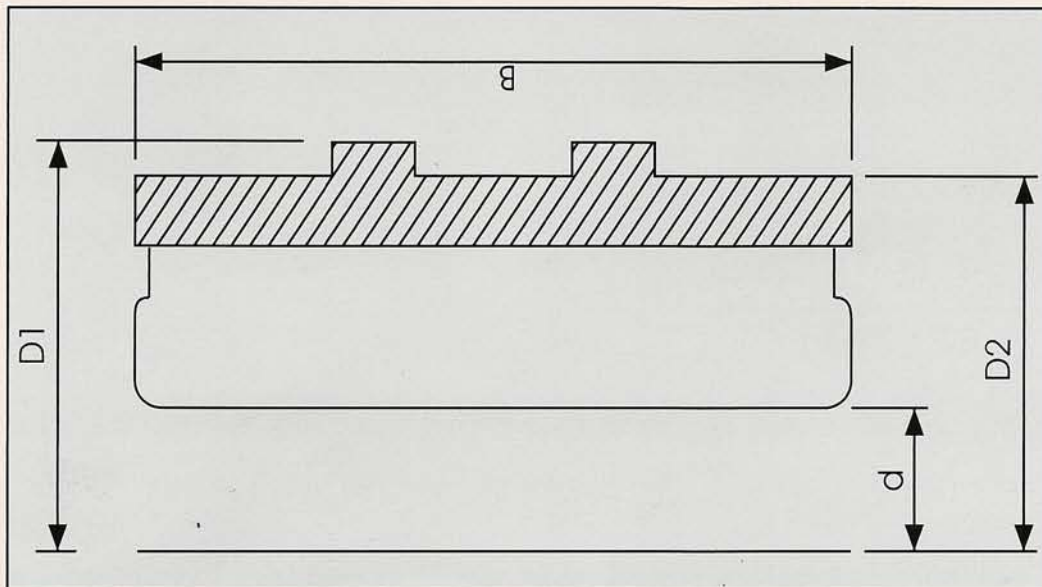
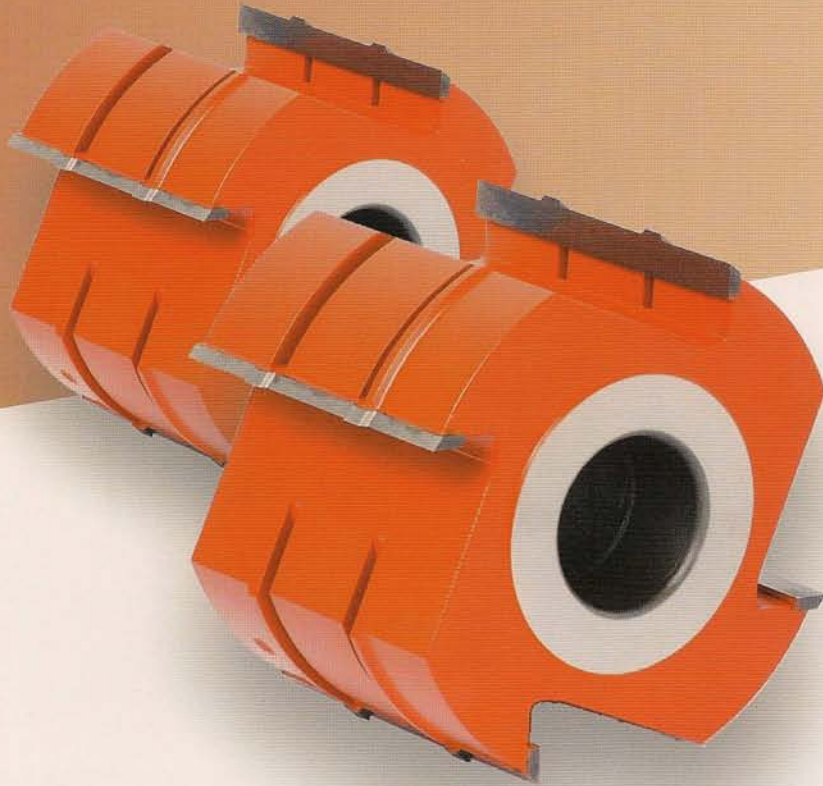

KS CUTTERS

專業製造 · 各種型體刀 · 木工刀具 · 超硬刀具

機 械	編 號	直 徑	長 度	內 徑	刃 數
MACHINE	ITEM NO.	D1=mm	B=mm	d=mm	Z
四面鉋棒刀 FOUR SIDE MOULDER	KS--801	D1=128, D2=125	100	40/50	4T/6T
四面鉋棒刀 FOUR SIDE MOULDER	KS--802	D1=128, D2=125	130	40/50	4T/6T
四面鉋棒刀 FOUR SIDE MOULDER	KS--803	D1=128, D2=125	160	40/50	4T/6T
四面鉋棒刀 FOUR SIDE MOULDER	KS--804	D1=128, D2=125	180	40/50	4T/6T

長方榫刀

RECTANGULAR TENONER CUTTER

新型專利申請中
(PATENT BEING APPLIED)

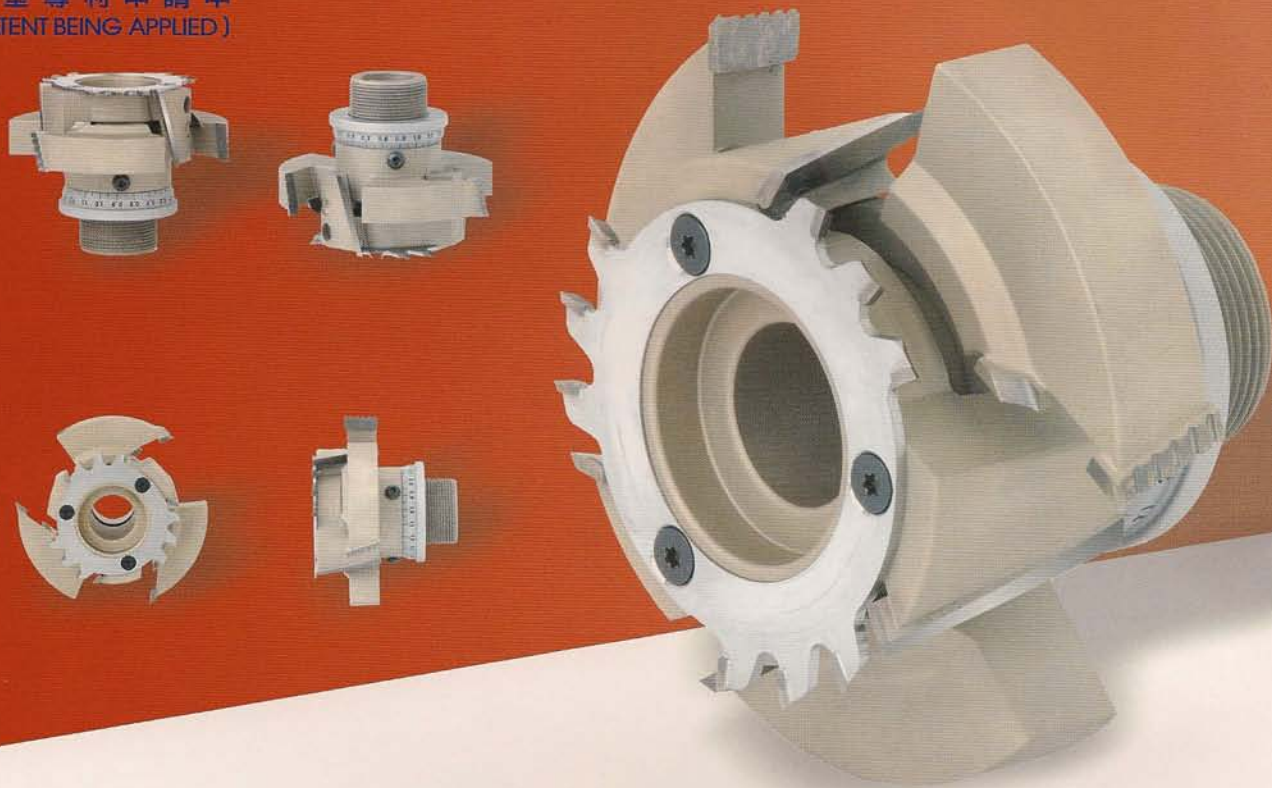

KS CUTTERS

專業製造 · 各種型體刀 · 木工刀具 · 超硬刀具

項目 ITEM	尺寸 SIZE	外徑D (mm)	長度B (mm)	內徑d (mm)	刀數Z
平刀 PLANING CUTTER		90	96	30	3
鋸片 SAW BLADE		91.5	2.8	50	9
粉碎刀 CHIPPING CUTTER		130	40	45	3

本刀具特點：

FEATURES :

- (1) 採用鋸片式割刀，以增加木料切削面的光滑度，亦可改善木料易焦黑的現象。

BLADE-CUTTER TO IMPROVE THE SMOOTH OF CUTTING SURFACE AND PREVENT WOOD BURNING.

- (2) 粉碎刀的刀紋呈螺紋狀設計，可破壞木材纖維組織，粉碎時較不會產生端裂，可提昇製成長方榫的成功率。

SPIRAL CHIPPING CUTTER CAN DESTROY THE WOOD FIBER AND PREVENT END CRACKES. THE TENONER CAN BE WELL MADE AT A HIGH PERCENTAGE.

- (3) 榫頭長度使用微調定位環調整，可微調精度達0.05m/m，可節省校刀時間。

THE TENONER LENGTH CAN BE ADJUSTED BY THE MICRO-ADJUSTED POSITIONING RING, THE ACCURACY BAN BE 0.05MM. IT WILL SAVE THE TIME OF THE CUTTER ADJUSTMENT.



四面框及拼板榫刀

FRAME AND BOARD COMPOSING CUTTER



說明：

其他尺寸可訂做必須指定木材厚度多少mm至多少mm
 The other Specifications can be customized.
 Please specify the thickness of the wood materials.

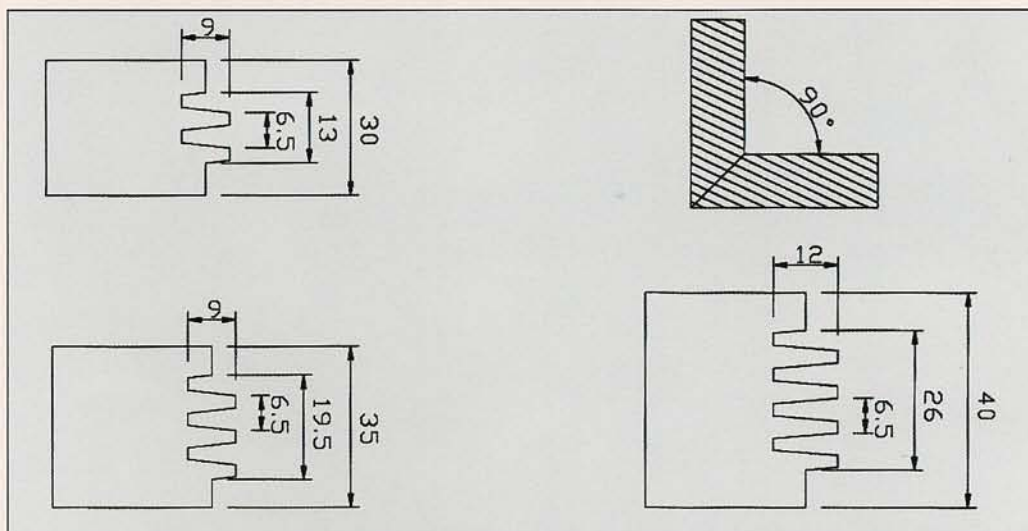

編號	外徑	厚度	內徑	刃數
ITEM NO.	D(mm)	B(mm)	d(mm)	Z
KS-1001	109/143	30	25.4/30/31.75/35/40	4T
KS-1002	109/143	35	25.4/30/31.75/35/40	4T
KS-1003	109/143	40	25.4/30/31.75/35/40	4T
KS-1004	109/143	50	25.4/30/31.75/35/40	4T
KS-1005	112/149	30	25.4/30/31.75/35/40	4T
KS-1006	112/149	35	25.4/30/31.75/35/40	4T
KS-1007	112/149	40	25.4/30/31.75/35/40	4T
KS-1008	112/149	50	25.4/30/31.75/35/40	4T

KS CUTTERS

專業製造 · 各種型體刀 · 木工刀具 · 超硬刀具

多片型指接刀

MULTI-BLADE FINGER JOINTING CUTTER

編號	外徑	厚度	內徑	刃數
ITEM NO.	D(mm)	B(mm)	d(mm)	Z
KS-1101	160	3.7	50/70	2T/4T
KS-1102	160	4.0	50/70	2T/4T
KS-1103	160	10.0	50/70	2T/4T

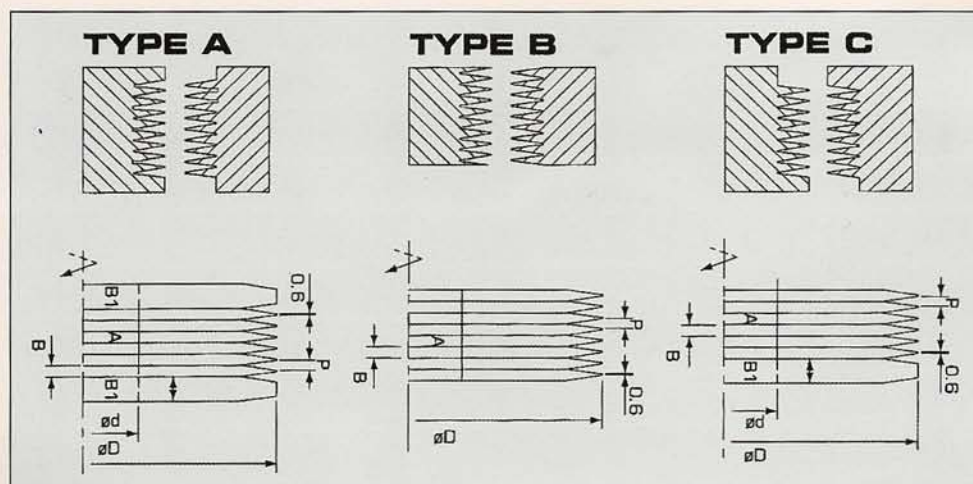

肚板刀

DOOR PANEL RAISING CUTTER



門框榫刀

DOOR FRAME JOINTING CUTTER

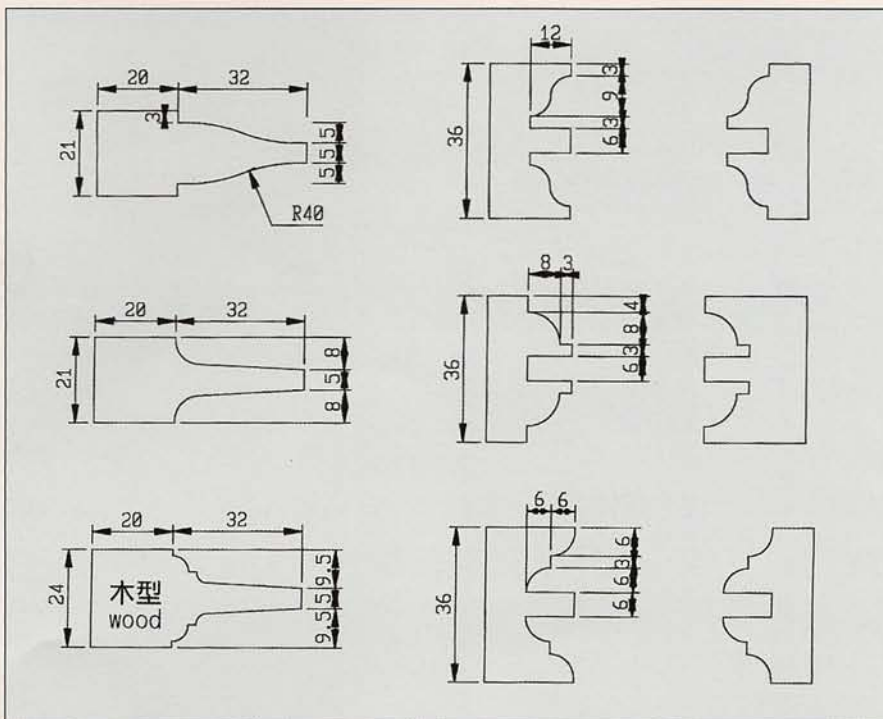
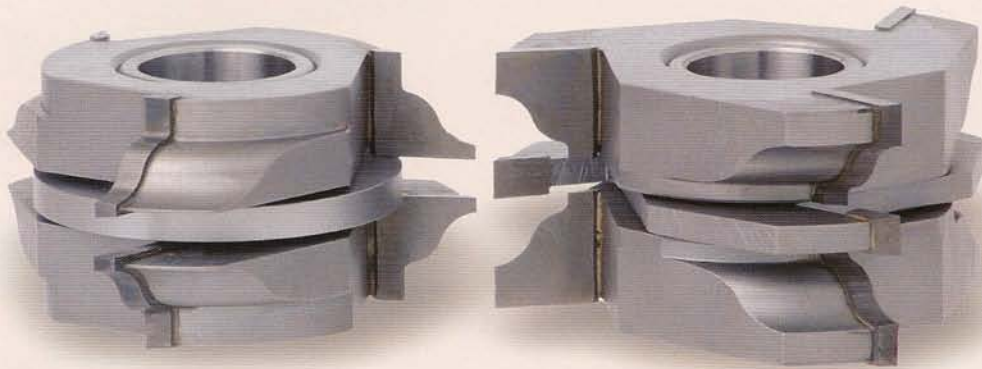

KS CUTTERS

專業製造 · 各種型體刀 · 木工刀具 · 超硬刀具

線條型刀

LINE PROFILE CUTTER

KS CUTTERS

專業製造 · 各種型體刀 · 木工刀具 · 超硬刀具



編號	外徑	長度	內徑	刃數
ITEM NO.	D(mm)	B(mm)	d(mm)	Z
KS-1301	140	50	40	4T/6T
KS-1302	140	75	40	4T/6T
KS-1303	140	100	40	4T/6T
KS-1304	140	125	40	4T/6T
KS-1305	140	155	40	4T/6T

鑽石砂輪

DIAMOND SANDING WHEEL



外徑	寬度	厚度	孔徑	粒度
D	W	B	d	SDC
150	10	2	17	500/600
150	6	1	17	500/600

砂輪材質 (1) 樹脂台 (2) 鋁合金台

Material of emery wheel platform:

(1) Resin platform

(2) Aluminium alloy platform

鉋刀片

PLANING KNIFE

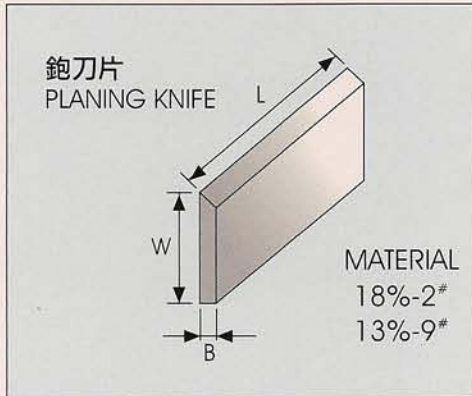

長度	寬度	厚度	材質
L (mm)	W (mm)	B (mm)	CARBIDE
3''~24''	30	3	TCT/H.S.S
3''~24''	38	6	TCT/H.S.S

抽圓棒刀

ROD MILLING CUTTER

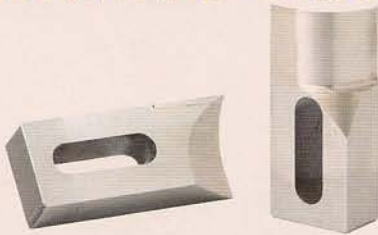

厚度	寬度	長度	材質
B (mm)	W (mm)	L (mm)	CARBIDE
6	19	46	TCT/H.S.S
12	30	70	TCT/H.S.S
18	30	70	TCT/H.S.S

鋸片

SAW BALDE



外徑	厚度	孔徑	刃數
D	B	d	Z
205	3.0	25.4/30	60T
255	3.0	25.4/50/70	30T
255	3.0	25.4/30	100T
305	3.0	25.4/50/70	36T
305	3.0	25.4/30	100T
305	3.0	25.4/30	120T
355	3.0	25.4/30	100T
355	3.0	25.4/30	120T
405	3.2	25.4/30	120T
455	3.4	25.4/30	120T

KS CUTTERS

專業製造 · 各種型體刀 · 木工刀具 · 超硬刀具



HOLYTEK

I SVERIGE AB

SE-512 91 Sexdrega

Tel +46 325 625547



KS CUTTERS

凱盛製刀有限公司
KAI SHENG KNIFE CO., LTD.

地 址：豐原市東北街39號

ADDRESS : NO.39, Tung Pei St., Feng Yuan,
Taichung, Taiwan 420

TEL : 886-4-2523-1339
886-4-2523-5143

FAX : 886-4-2523-6773

E-MAIL: ksknife@ms77.hinet.net
kaisheng39@yahoo.com.tw

http://www.kai-sheng.com.tw